

- Legend**
- LESS THAN 2-INCH
 - 2-INCH WATER LINE
 - 3-INCH WATER LINE
 - 4-INCH WATER LINE
 - 6-INCH WATER LINE
 - 8-INCH WATER LINE
 - 10-INCH WATER LINE
 - 12-INCH WATER LINE
 - CITY LIMITS
 - UGA
 - ▲ PRV STATION
 - WELL
 - RESERVOIR
 - BOOSTER PUMP STATION

CITY OF WINLOCK

FIGURE 1-3
EXISTING FACILITIES

Gray & Osborne, Inc.
CONSULTING ENGINEERS

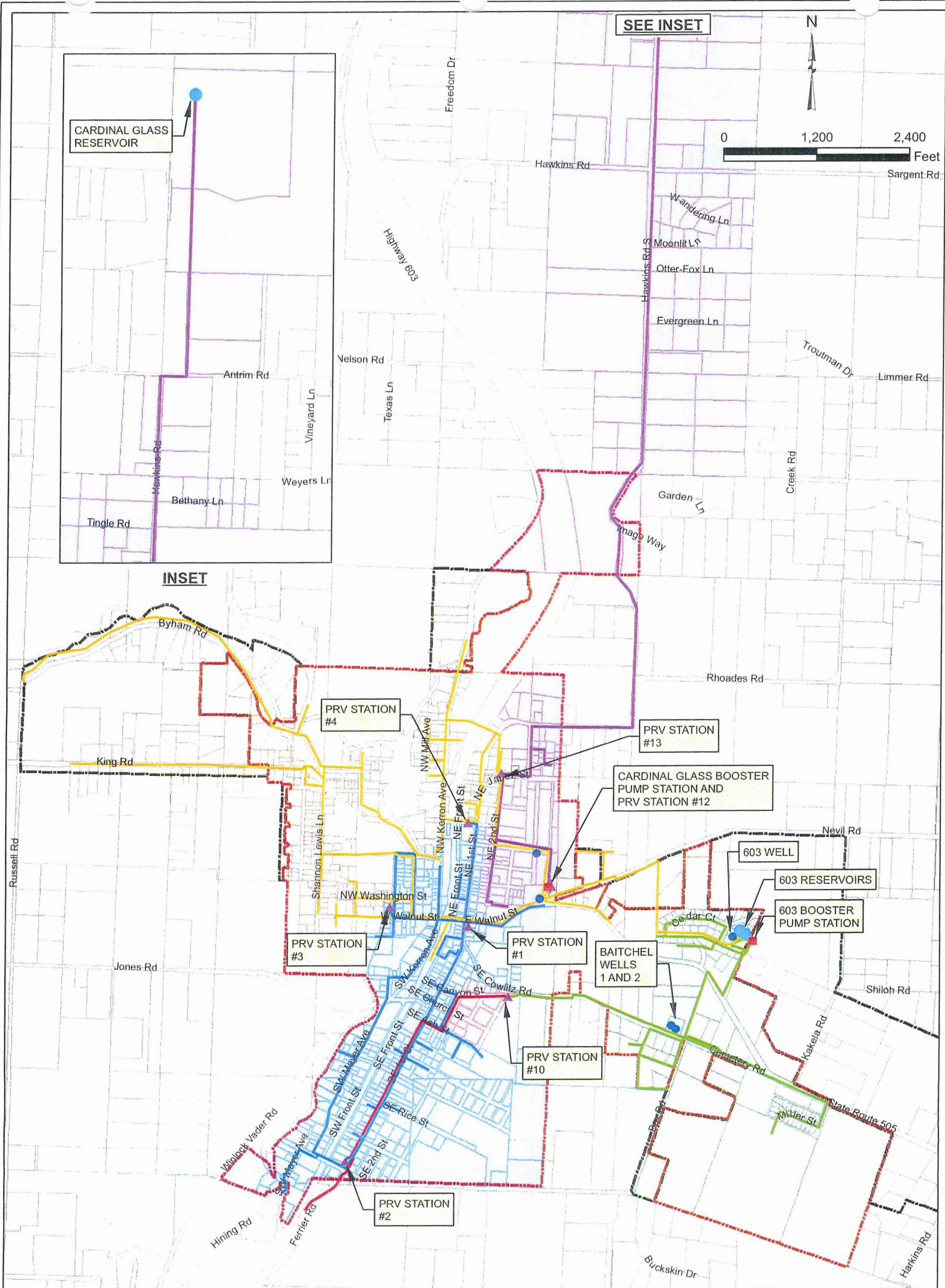

Legend

PRESSURE ZONES:

- ZONE 1 - 603 GRAVITY
- ZONE 2 - EAST SIDE BOOSTED
- ZONE 3 - SOUTHEAST REDUCED
- ZONE 4 - DOWNTOWN REDUCED
- ZONE 5 - NORTH SIDE

PRESSURE ZONE IDENTIFICATION:

- 603 RESERVOIR GRAVITY ZONE (ZONE 1)
- SOUTHEAST BOOSTED PRESSURE ZONE (ZONE 2)
- SOUTHEAST REDUCED PRESSURE ZONE (ZONE 3)
- DOWNTOWN REDUCED PRESSURE ZONE (ZONE 4)
- CARDINAL GLASS PRESSURE ZONE (ZONE 5)

- PRV STATION
- WELL
- RESERVOIR
- BOOSTER PUMP STATION
- CITY LIMITS
- UGA

CITY OF WINLOCK

FIGURE 1-4
PRESSURE ZONES



Gray & Osborne, Inc.
CONSULTING ENGINEERS

N

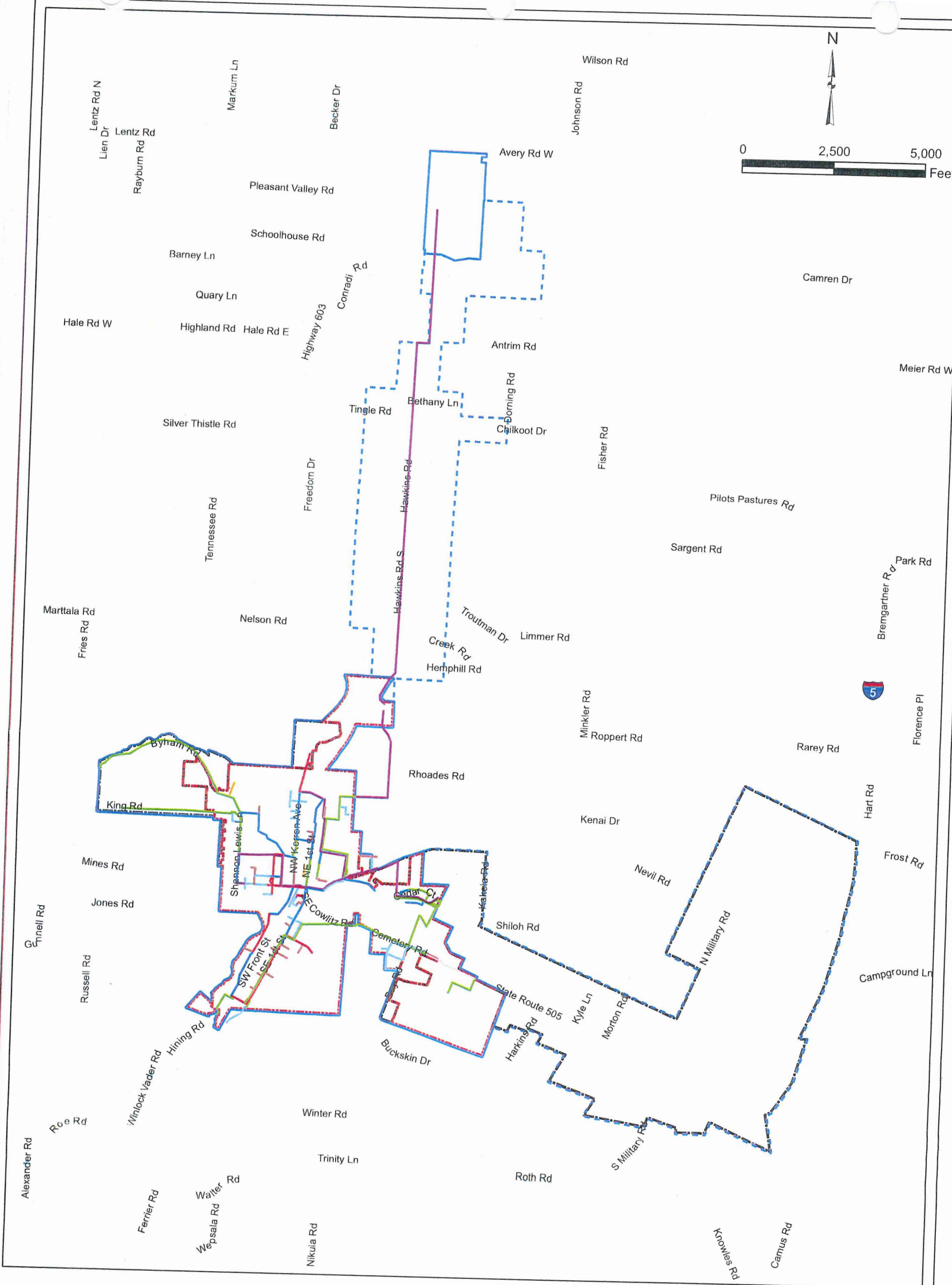
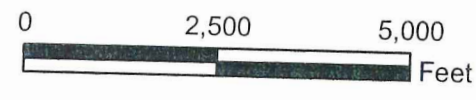

- Legend**
- LESS THAN 2-INCH
 - 2-INCH WATER LINE
 - 3-INCH WATER LINE
 - 4-INCH WATER LINE
 - 6-INCH WATER LINE
 - 8-INCH WATER LINE
 - 10-INCH WATER LINE
 - 12-INCH WATER LINE
 - EXISTING RETAIL WATER SERVICE AREA
 - FUTURE RETAIL WATER SERVICE AREA
 - CITY LIMITS
 - UGA

CITY OF WINLOCK
 FIGURE 1-5
 EXISTING AND FUTURE
 RETAIL SERVICE AREA BOUNDARIES



Gray & Osborne, Inc.
 CONSULTING ENGINEERS

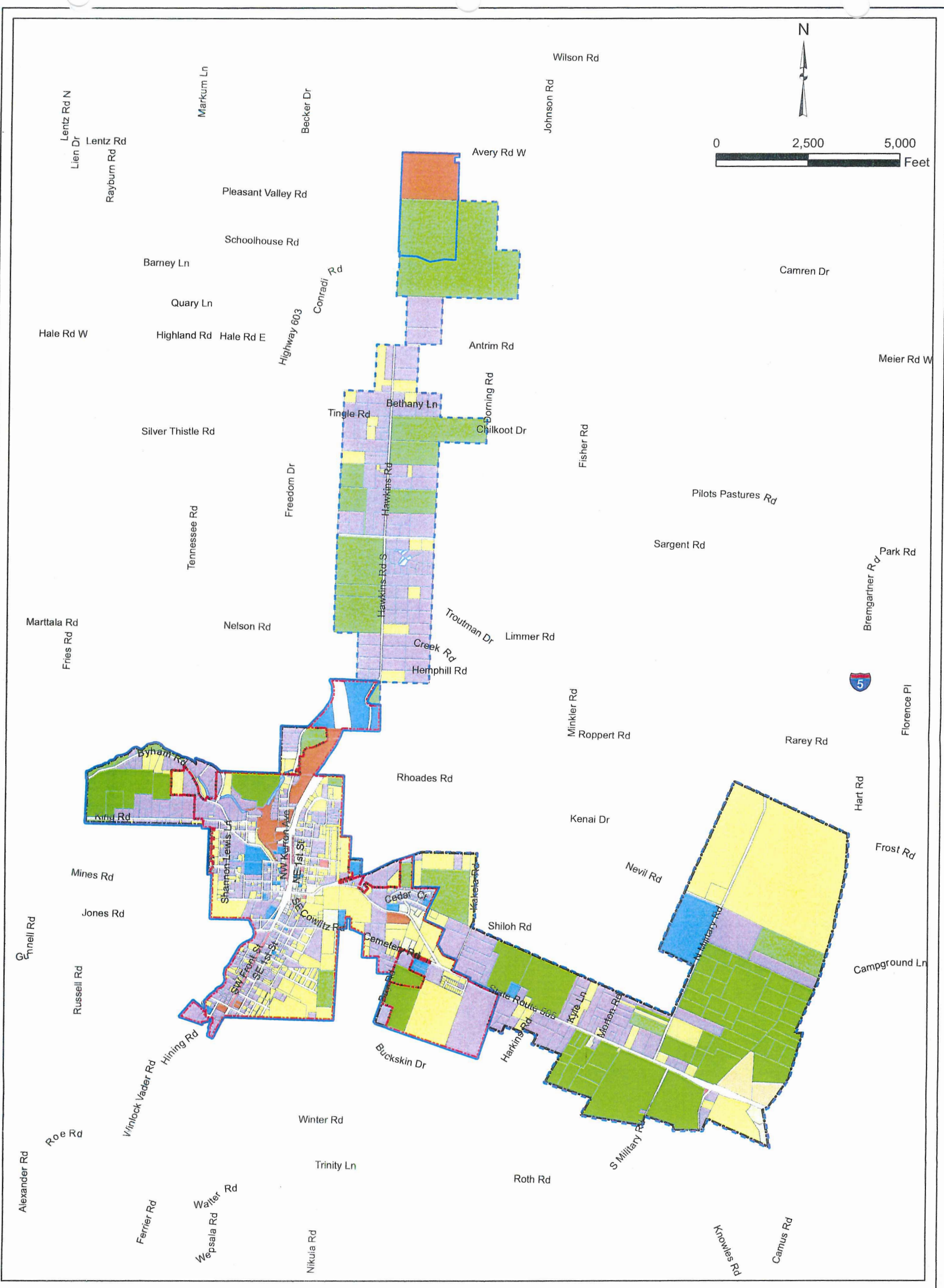

Legend

- | | | |
|------------------------------|--------------------------|---|
| LAND USE DESCRIPTION: | PUBLIC/QUASI-PUBLIC | EXISTING WATER SERVICE AREA |
| AGRICULTURE | SINGLE-RESIDENTIAL | FUTURE WATER SERVICE AREA AND RETAIL WATER SERVICE AREA |
| COMMERCIAL INDUSTRIAL | TRANSPORTATION/UTILITIES | CITY LIMITS |
| COMMERCIAL RETAIL | UNDEVELOPED/VACANT | UGA |
| MINING/FORESTRY | WATER | |
| MULTI-RESIDENTIAL | UNKNOWN | |

CITY OF WINLOCK

FIGURE 1-6
LAND USE MAP

Gray & Osborne, Inc.
CONSULTING ENGINEERS

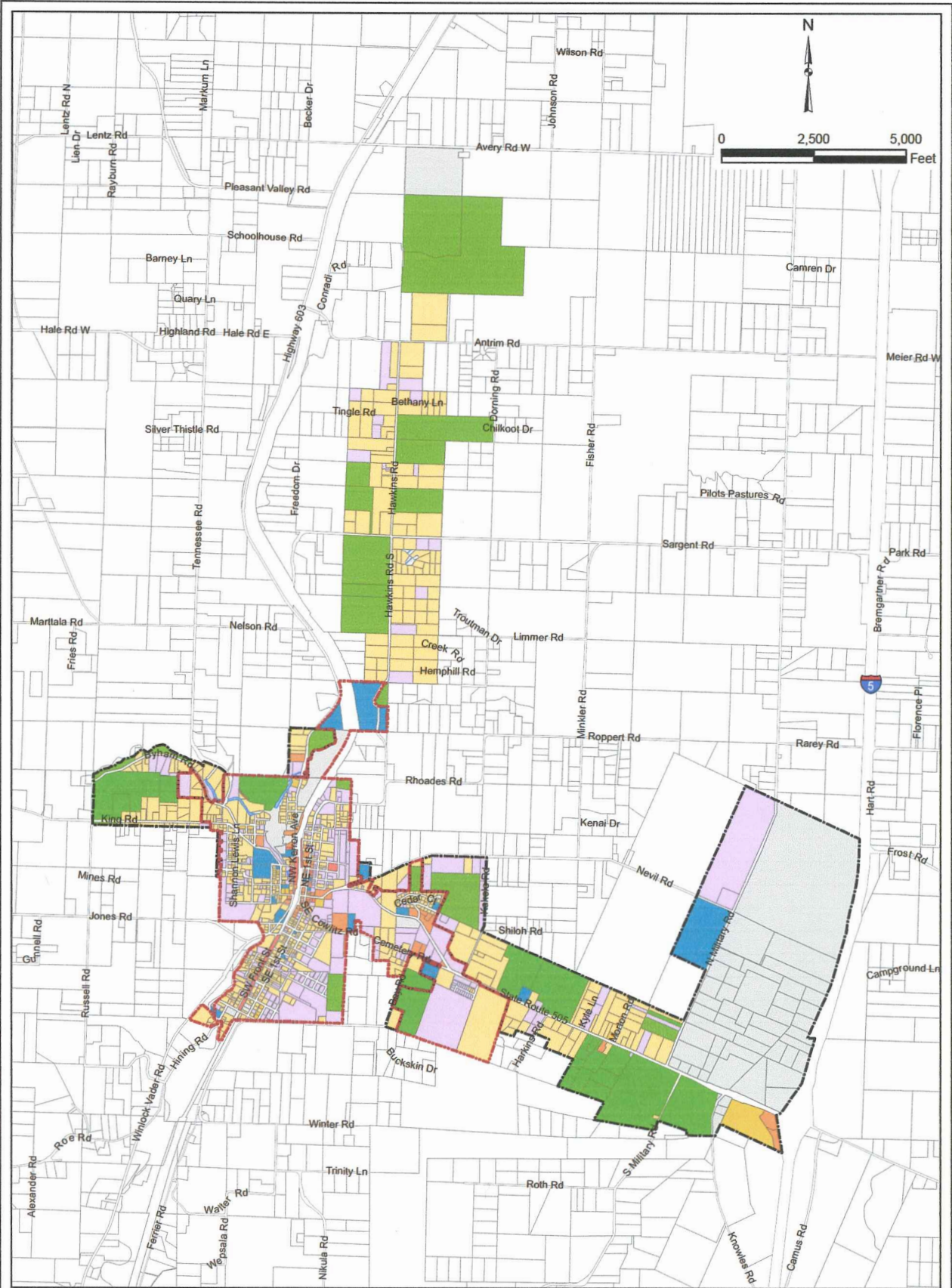

Legend

- | | |
|-----------------------|--------------------------|
| SINGLE-RESIDENTIAL | MINING/FORESTRY |
| MULTI-RESIDENTIAL | TRANSPORTATION/UTILITIES |
| COMMERCIAL INDUSTRIAL | PUBLIC/QUASI-PUBLIC |
| COMMERCIAL RETAIL | UNDEVELOPED/VACANT |
| AGRICULTURE | WATER |
| | UNKNOWN |
| | CITY LIMITS |
| | UGA |

CITY OF WINLOCK

FUTURE LAND USE MAP

Gray & Osborne, Inc.
CONSULTING ENGINEERS

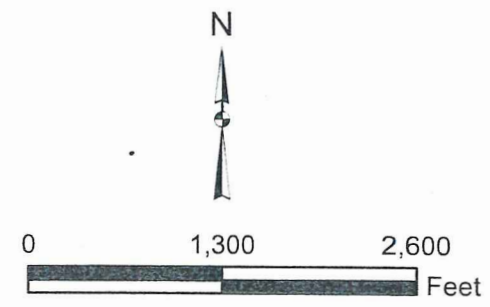
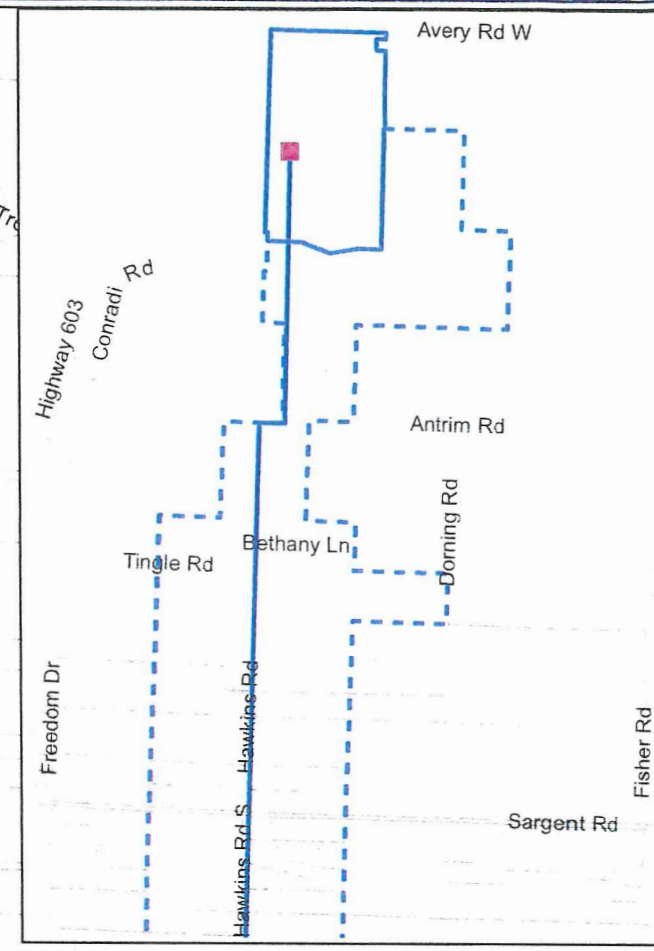
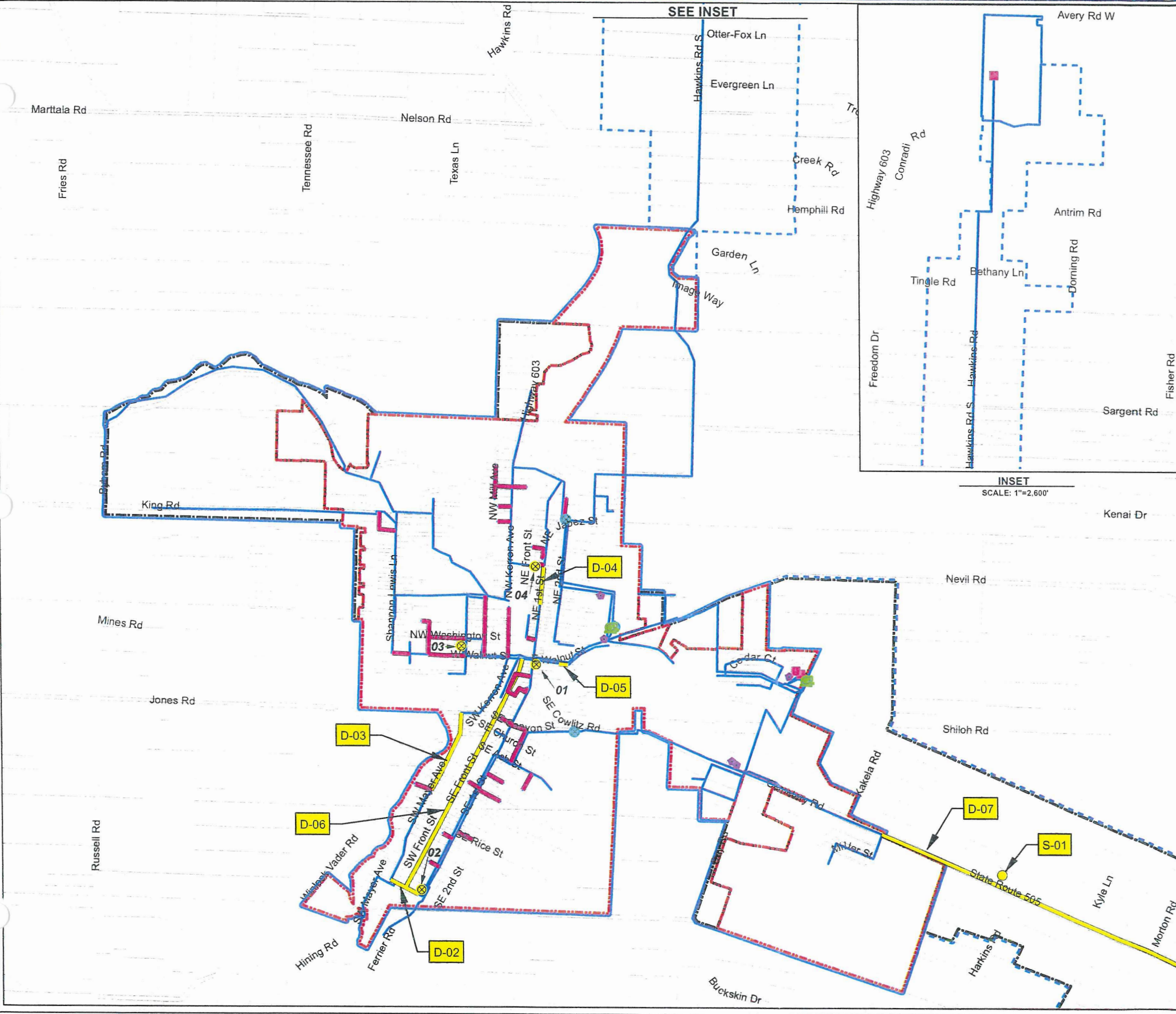

Legend

SYSTEM FACILITIES

- WELL
- PRV
- RESERVOIR
- BOOSTER PUMP
- WATER LINES
- EXISTING RETAIL WATER SERVICE AREA
- - - FUTURE WATER SERVICE AREA AND RETAIL WATER SERVICE AREA

CAPITAL IMPROVEMENTS

- REPLACE GI PIPE - PROJECT D-01
- CAPITAL IMPROVEMENTS
- ⊗ PRV 01, 02, 03 & 04
- - - CITY LIMITS
- - - UGA

CITY OF WINLOCK
 FIGURE 8-1
 CAPITAL IMPROVEMENTS

Gray & Osborne, Inc.
 CONSULTING ENGINEERS

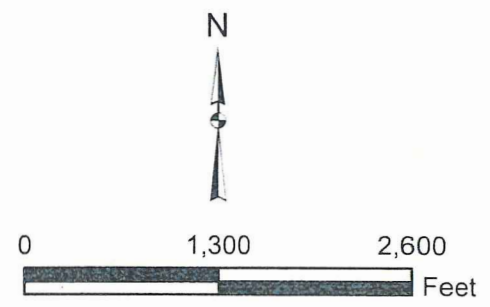
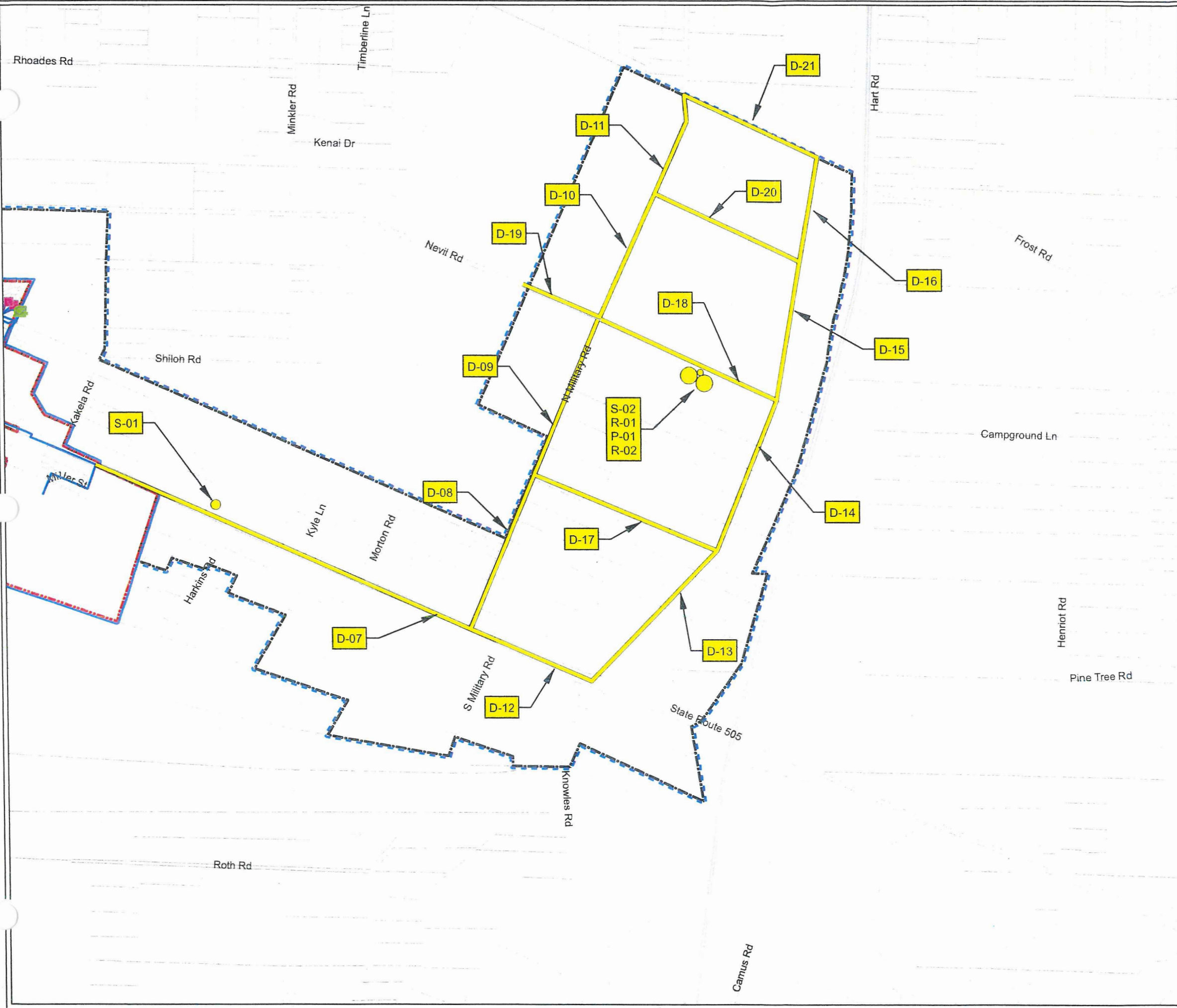

Legend

SYSTEM FACILITIES

- WELL
- PRV
- RESERVOIR
- BOOSTER PUMP
- WATER LINES
- EXISTING WATER SERVICE AREA
- FUTURE WATER SERVICE AREA AND RETAIL WATER SERVICE AREA

CAPITAL IMPROVEMENTS

- REPLACE GI PIPE - PROJECT D-01
- CAPITAL IMPROVEMENTS
- CITY LIMITS
- UGA

CITY OF WINLOCK
 FIGURE 8-2
 CAPITAL IMPROVEMENTS

Gray & Osborne, Inc.
 CONSULTING ENGINEERS

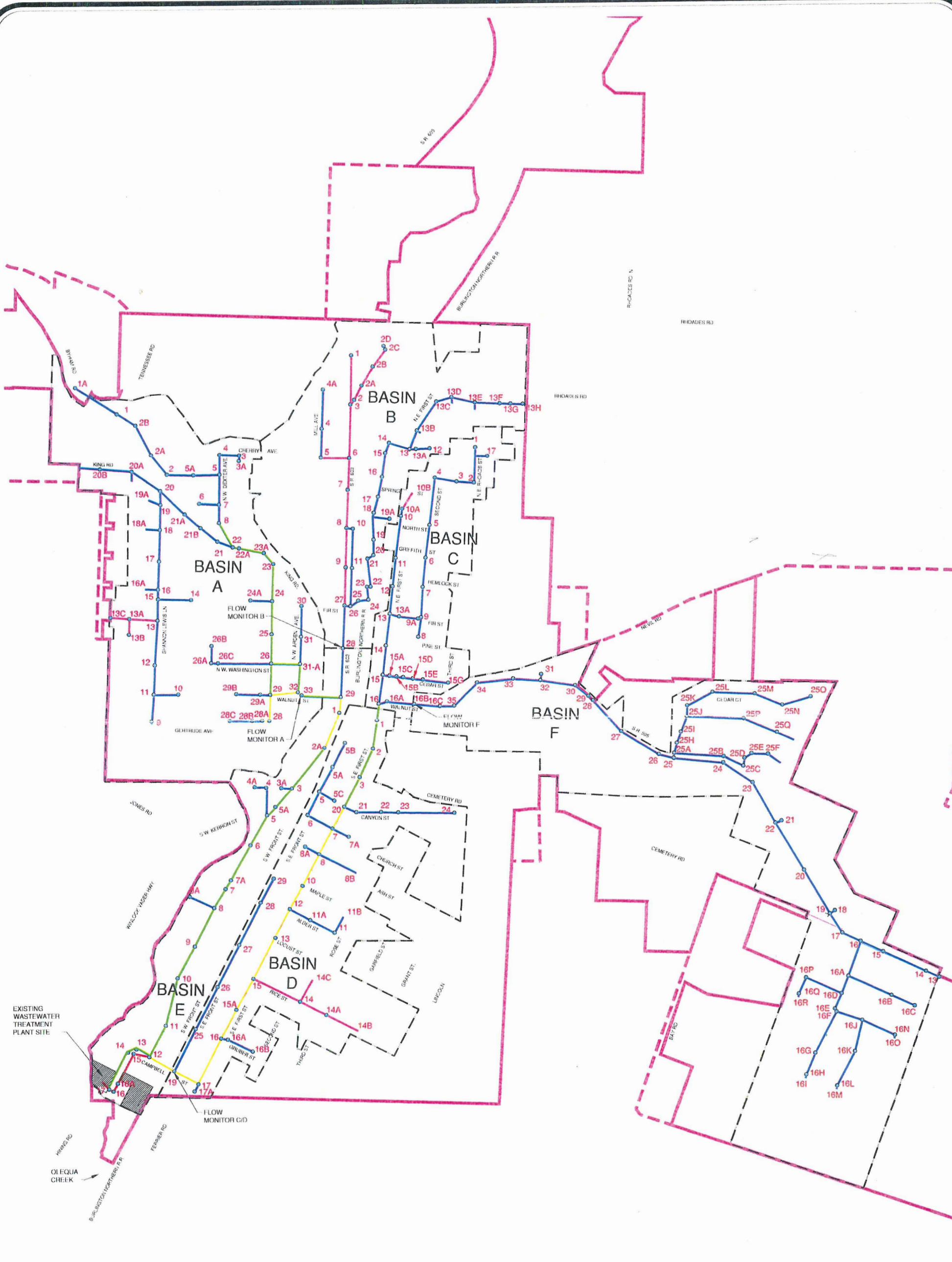

EXISTING WASTEWATER TREATMENT PLANT SITE

OL EQUA CREEK

NOTE: ALL MANHOLE LOCATIONS AND PIPE LENGTHS ARE TO BE FIELD VERIFIED BEFORE THIS INFORMATION IS USED FOR CONSTRUCTION.

REFERENCE: PARCEL INFORMATION FROM LEWIS COUNTY GIS.

- EXISTING CITY LIMITS
- - - EXISTING URBAN GROWTH AREA
- - - BASIN BOUNDARY
- 18" GRAVITY SEWERLINE
- 12" GRAVITY SEWERLINE
- 10" GRAVITY SEWERLINE
- 8" GRAVITY SEWERLINE
- 6" GRAVITY SEWERLINE
- SEWER MANHOLE

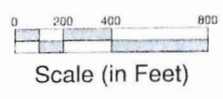

CITY OF WINLOCK
WASTEWATER COLLECTION SYSTEM INVENTORY MAP